



# Product Description

## HID-PrimaVision (Xtreme) for CDM Elite MW

Compact, robust, one-piece, electronic ballast for 250W CDM lamps

### Benefits

- Most efficient white-light system in the industry in its power range
- Xtreme technology
- Designed to minimize maintenance cost in outdoor lighting
- Accurate power stabilization
- No down-time due to calamities (storms, lightning strikes, etc)
- Same energy consumption and smooth driving of the lamp regardless of fluctuations in the mains voltage

### Features

- Up to 92% system efficiency
- Standard outdoor gear (90% survival after 50 000 hours at  $T_c=80^\circ\text{C}$ )
- Standard 4kV/2kV common / differential mode surge protection
- Optional Xtreme technology (90% survival after 80 000 hours at  $T_c=80^\circ\text{C}$ )
- Optional 5kA / 10kV lightning strike protection
- 95-97% accuracy on power stabilization when mains voltage remains between 180-300V

### Application

- Floodlighting
- Shop lighting
- Indoor and outdoor applications, recommended outdoor luminaire classification > IP 23

Related products



Dimensional drawing

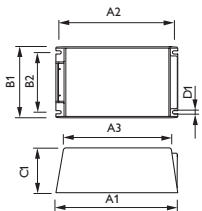

Product	A1 (Norm)	A2 (Norm)	B1 (Norm)	B2 (Norm)	C1 (Norm)	D1 (Norm)
HID-PV 315 /S CDM 220-240V 50/60Hz	215.0	204.5	128.5	111.5	60.0	4.2
HID-PV 150 /S CDM 220-240V 50/60Hz	-	-	-	-	-	-

Compare table

Order code	Full product name	Rated Number of Lamps	Housing	Rated Lamp-type	Line Voltage	Line Frequency	Rated Ballast-Lamp Power
843118 00	HID-PV 315 /S CDM 220-240V 50/60Hz	1	/S	CDM	220-240	50/60	315
907384 00	HID-PV 150 /S CDM 220-240V 50/60Hz	1	/S	CDM	220-240	50/60	150



© 2011 Koninklijke Philips Electronics N.V.  
All rights reserved.

Specifications are subject to change without notice. Trademarks are the property of Koninklijke Philips Electronics N.V. or their respective owners.

[www.philips.com/lighting](http://www.philips.com/lighting)

2011, March 28  
data subject to change